

2008 Bond Update

2008 Program Goals

- Build capacity across the College
 - Additional classrooms at all 4 campuses, Washington County, Newberg
 - Renovation of existing classrooms
 - Provide student childcare at multiple sites
 - Expand educational opportunities at Southeast Center
- Upgrade CTE capability
- Upgrade technology
- Life safety, security, and accessibility upgrades

2008 Bond Financials

Original Bond passed by voters \$374 million

Sources of revenue:

- Proceeds 2009 General Obligation bond sale: \$200 million
- Proceeds 2013 General Obligation bond sale: \$174 million
- Premium & investment earnings: \$47.2 million
- State support: \$24.4 million
- Other sources: \$13.3 million

Total Revenue: \$458.9 million

2008 Bond Financials (continued)

Cascade

Budget: \$59.8M

Spent to date: \$59.8M

Percentage complete: 100%

Southeast

Budget: \$54M

Spent to date: \$53.9M

Percentage complete: 99.8%

Rock Creek

Budget: \$65.6M

Spent to date: \$65M

Percentage Complete: 99.1%

Sylvania

Budget: \$74.7M

Spent to date: \$74.3M

Percentage Complete: 99.5%

All Other College-Wide

Budget: \$188M

- Willow Creek Center
- Downtown Center
- Newberg Center
- Swan Island Trades Center
- Columbia County
- Property purchases
- Maintenance, IT, and Security Upgrades

Spent to date: \$183.6M

Percentage Complete: 97.7%

2008 Bond Financials (continued)

Total:

Construction Budget: \$458.9M

Spent to date: \$436.9M

Percentage complete: 95.2%

Cascade Campus: Complete

- Campus Master Planning
- New Student Union
- New Academic Building
- Underground Parking Garage
- Renovated Library, tear down of old Student Center, and site improvements
- Renovations in TEB & SSB
- Renovate Paragon
- Childcare

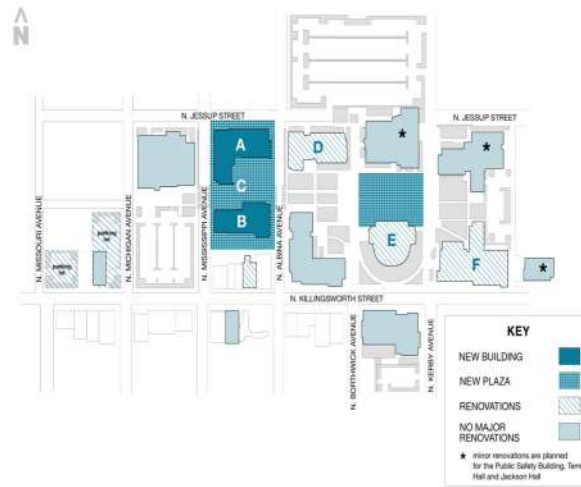

Southeast Campus: Complete

- Property acquisition
- New Student Commons
 - Retail
- New Library
 - Retail
- Mt. Tabor renovations
- Site improvements
- 1911 Building renovation
 - Campus Administration
 - Childcare

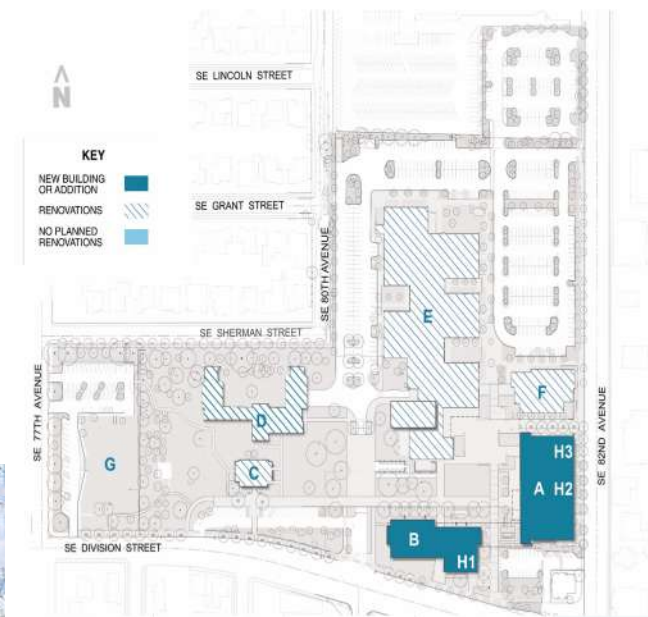

Rock Creek Campus: Complete

- Property acquisition
- Campus Master Planning
- Major additions to B7 and B5
- Renovations:
 - B1, B2, B3, B9
- West Campus & Farm improvements
- New egress road
- Solar installation
- Seismic upgrades
- Childcare Center

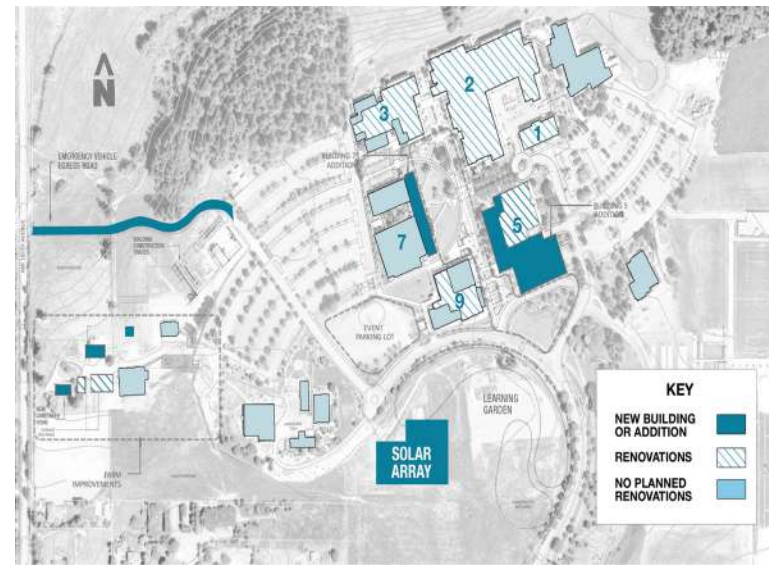

Sylvania Campus: Complete

- Campus Master Planning
- New AM Storage building
- Site improvements
- Renovations & Seismic
 - AM
 - CT
 - HT
 - SS
 - ST
 - Library
- CC Building
 - ADA improvements
 - E6 energy efficiency
 - Multi-phased renovation
 - East entry
- New Child Development Center

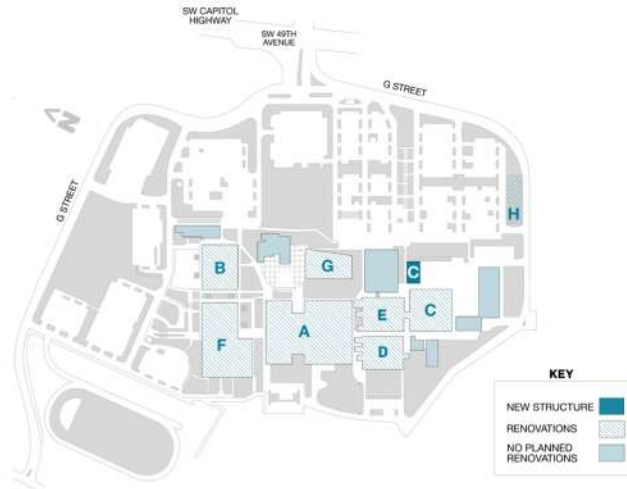

Centers



Swan Island



Willow Creek



Downtown



Newberg

4th & Montgomery



Main building entry





View into courtyard from 5th Avenue



Dental Assisting



Dental Clinic

College-Wide Projects

Safety & Security

- Access control & video surveillance
- Mass notification
- Generator upgrades

Information Technology

- Wireless
- VoIP (Phone System)
- Upgrades:
 - Telecom rooms
 - Classroom podium upgrades
 - Network equipment

Facilities Plan – Phase I

Deferred Maintenance

- Roofing
- Arc Fault (electrical)
- Parking lot and site lighting upgrades
- Painting
- Mechanical unit upgrades
- Fire/Life/Safety upgrades
- Pool upgrades
- Domestic water line upgrades

2008 Projects to Complete

- Columbia County (OMIC)
- Health Professions Dental Program
 - PCC/PSU/OHSU/CoP Partnership
- College-Wide signage upgrades

Student Impact

- Improved student spaces
 - Student Services
 - Resource Centers
 - Flexible study and gathering spaces
- Improved accessibility
- More classrooms added and many outdated classrooms upgraded
- Re-envisioned Libraries
 - Increased access to computers
 - Consolidation of services

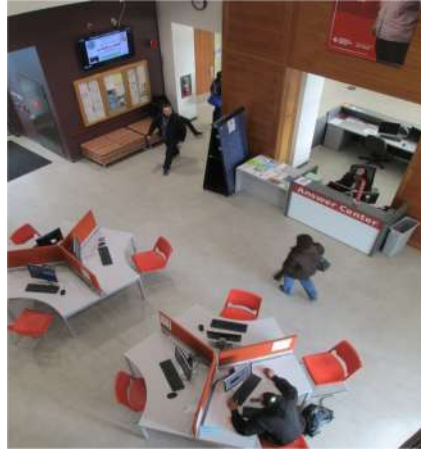

Program Enhancements & Acknowledgments

- LEED
 - Cascade: LEED Gold
 - Rock Creek: LEED Gold
 - Southeast: LEED Silver
 - Willow Creek: Platinum
 - Newberg: Platinum
- DJC: Cascade Hall 2015 Top Projects 2nd Place
- SCUP: Presentations at several regional conferences
- Planning: TDM update, SW Corridor, CoP Comprehensive Plan, North Bethany Planning, Facilities Planning
- MWESB: Goals met and GC mentoring and capacity building



Successes

- Largest bond in the State of Oregon at the time
- Re-established relationship and trust with community
- Active student participation (internships, class projects, guest lectures, and design and committee participation)
- Ability to strategically incorporate new facilities and programs
 - Swan Island Trade Center
 - Columbia County
 - Extensive renovation work at Sylvania
 - Emergency generators across the College
 - Seismic upgrades
 - Southeast Campus 1911 building renovation
- Building capacity in MWESB general contractors

Planning for PCC's future

- Built capacity without the MWESB Communities
- Planning
 - Facilities Plan Phase 1 : Groundwork for 2017 Bond
 - Alignment with other college initiatives
 - Comprehensive college-wide planning
 - Facilities Plan Phase 2
 - Forecasting for future bond measures
 - Housing
 - Importance of continual planning and planning department