

Portland Community College Newberg Center

July 27, 2017

Board of Directors Meeting

Tonight

- Our people
- Our place
- Our programs
- Our partners
- Our plans

Our Context

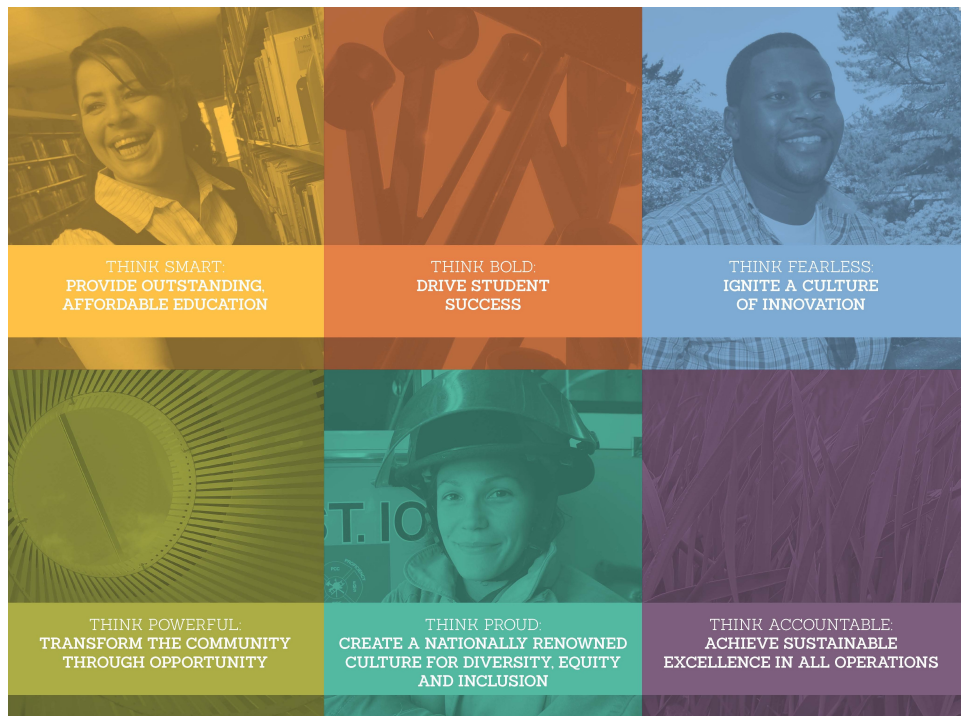

Our People



Provide Outstanding, Affordable Education - Drive Student Success

Fall 2016 Student Demographics

| Ethnic | Count | % |
|--------------------|-------|----|
| White | 211 | 65 |
| Hispanic/Latino | 60 | 18 |
| Multiracial | 9 | 2 |
| Asian | 7 | 2 |
| Native Amer | 2 | >1 |
| Black Amer/African | 1 | >1 |
| Pacific Is | 1 | >1 |
| Not specified | 31 | 9 |

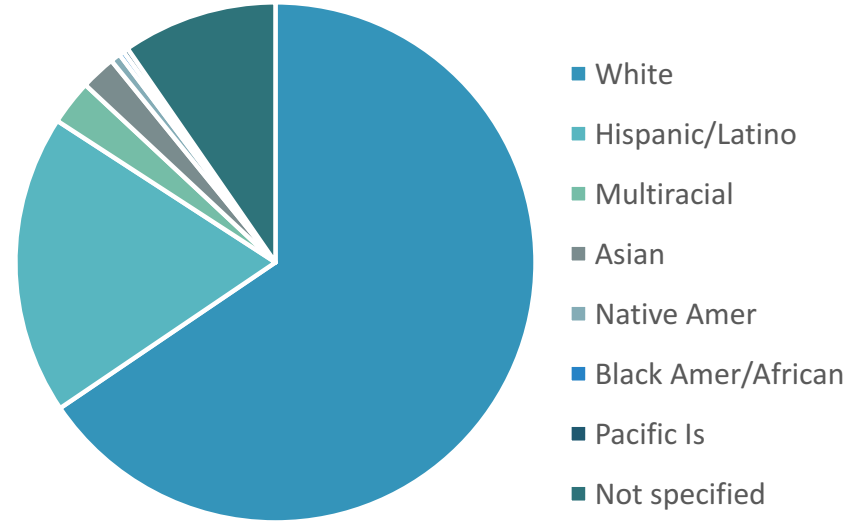

322 students total

Newberg Center Students

Students Fall 2016

- 170 Female (52.4%)
- 144 Male (44.4%)
- **18%** enrolled in remedial/pre-college classes
- **10%** enrolled in career technical classes
- **73%** enrolled in lower division transfer classes

Enrolled

- Part-time (1-5cr) 13.5%
- Half-time (6-11cr) 40.4%
- Full-time (12+cr) 46.2%
- 42.8% are 19 years old or under
- Average age = 27



Enrollment Trends

- 2013-14 = 168.83 FTE
- 2014-15 = 174.05 FTE
- 2015-16 = 153.76 FTE
- 2016-17 = 130.58 FTE

Our Place

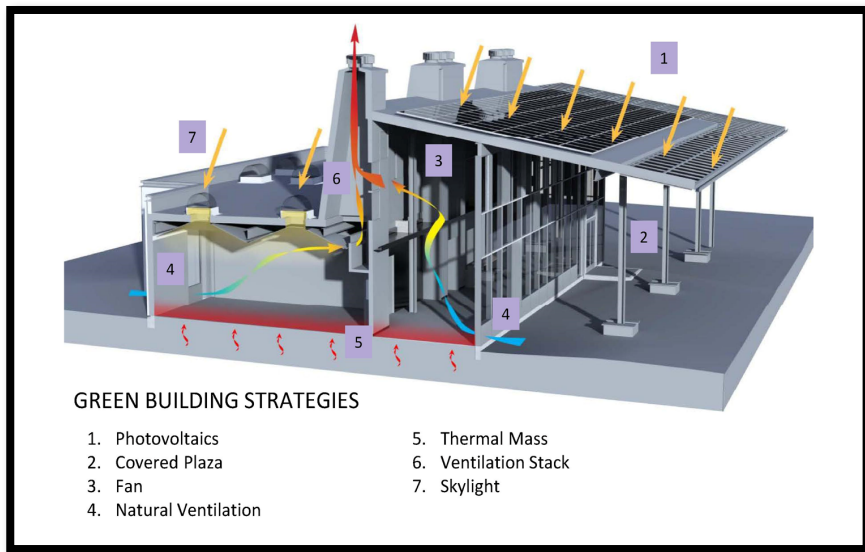

GREEN BUILDING STRATEGIES

- 1. Photovoltaics
- 2. Covered Plaza
- 3. Fan
- 4. Natural Ventilation
- 5. Thermal Mass
- 6. Ventilation Stack
- 7. Skylight

Achieve Sustainable Excellence in All Operations

In the Garden



Transform the community through opportunity

In the Garden



Transform the community through opportunity

In the Garden



In the Garden

May Peace Prevail On Earth

■ PCC Newberg Center students, staff and faculty dedicated a new Peace Pole in the Newberg Center Learning Garden. The Peace Pole was a part of larger project to plant fifty poles in Newberg, sponsored by the Newberg Rotary Clubs and the Jubitz Family Foundation.



Our Program

- Pre-college courses
- LDT & CTE courses
- Non-credit offerings
- Student Services:
 - Testing
 - Orientation
 - Advising
 - Welcome Day
 - Oregon Promise Day
- Career Counseling
- Personal Counseling
- Disability Services
 - Counseling
- Learning Garden activities
- Workshops
 - Scholarship

NC Courses

- American Sign Language
- Introduction to Photography
- Introduction to Business
- College Survival & Success
- Public Speaking
- Microsoft Office Classes
- Computer Information Systems Intro
- Spanish
- History
- Philosophy
- Literature
- Psychology
- Geography
- Economics
- Reading
- Writing
- Math
- Stress and Human Health
- Personal Health
- Sociology in Everyday Life
- Beginning Fitness & Walking

Our Partners

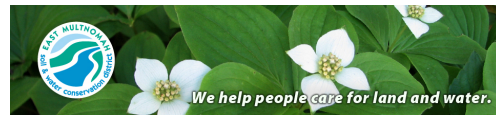

Transform the community through opportunity



In the Community

- **Classes**

- PCC Welding classes offered at Newberg High School in the evenings
- Dual credit and Expanded Options Program for local high schools

- **Events**

- Working with local high schools for events and tours, financial aid days and more
- Participating in Newberg Old Fashion Festival & Sherwood Robin Hood Days
- Sponsoring Tunes on Tuesday with the Chamber

- **Sharing Spaces**

- Chehalem Parks & Recreation District
- Learning Garden at Newberg Center
- Sherwood YMCA
- Community events on site



In the Community

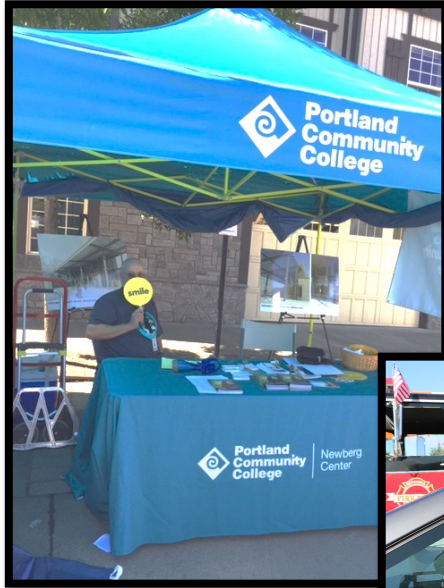

Community Scholarships

- PCC Foundation Scholarships
 - Newberg Steel & Fabrication for NHS student with one welding course to attend PCC Welding program
 - Students with Mexican heritage who are graduates of Newberg, Sherwood or St. Paul
 - Resident of Chehalem Valley
- Rotary Youth Leadership Awards (RYLA)
 - NC students awarded scholarships in past years

Our Plans

- Magnify marketing efforts to increase enrollment
- Expand course options by utilizing learning garden (lab science)
- Explore programming partnerships with local schools, business, and community agencies
- Partner with FMS to pursue NetZero status
- Continue to refine emergency management protocols in conjunction with DPS and community partners

Questions? Comments?

