



**Portland
Community
College**

Planning and Capital Construction | Building Our Future

PCC Sylvania Health Technology Building

Campus Update

Fall, 2021

HACKER

LEASE CRUTCHER
lewis

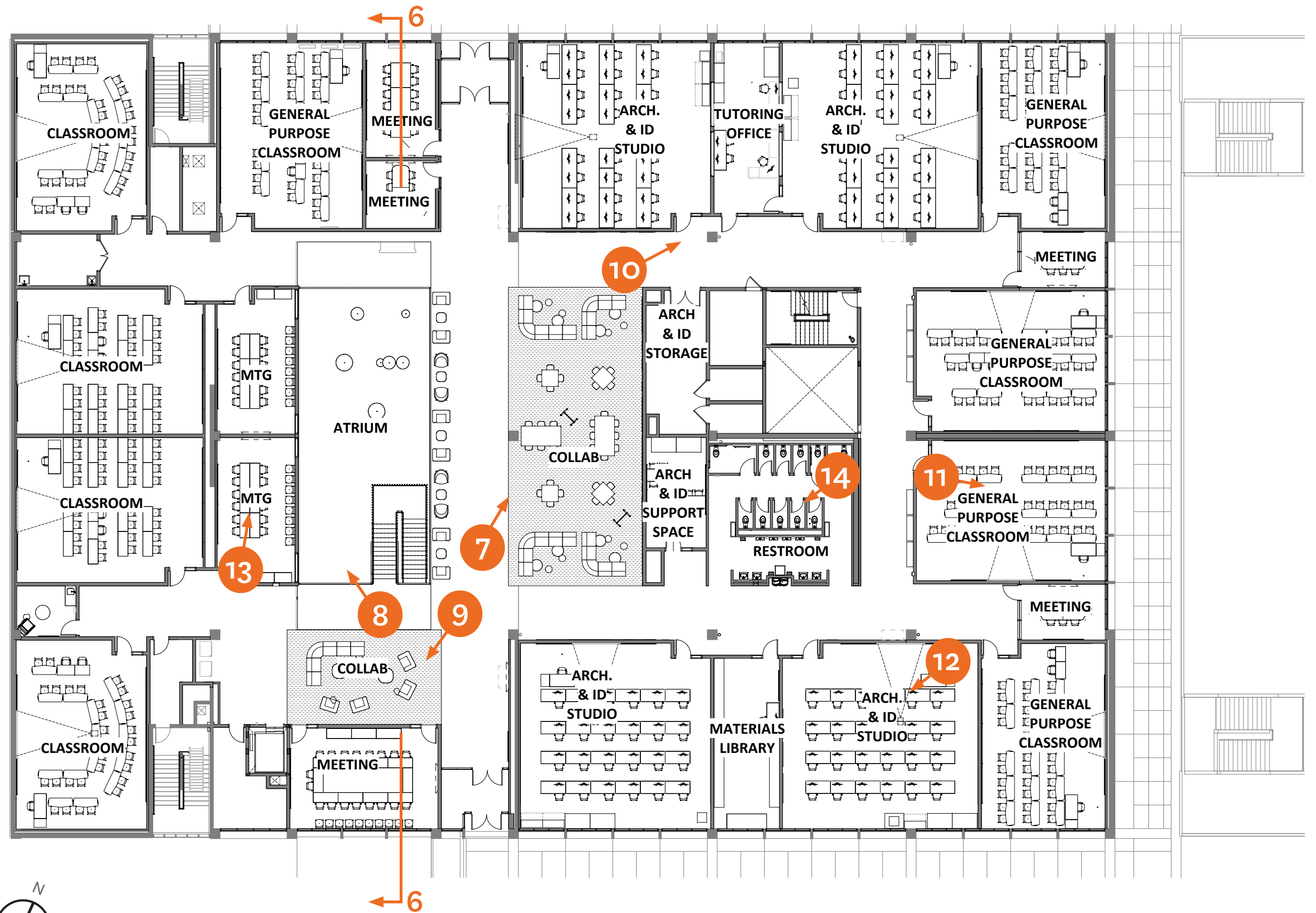

Level 3 | Floor Plan Key



These floor plans are provided to help orient the viewer to each view on the following pages. Arrows indicate the location and direction of view, numbers correspond to the page of the view.



Level 2 | Floor Plan Key



These floor plans are provided to help orient the viewer to each view on the following pages. Arrows indicate the location and direction of view, numbers correspond to the page of the view.

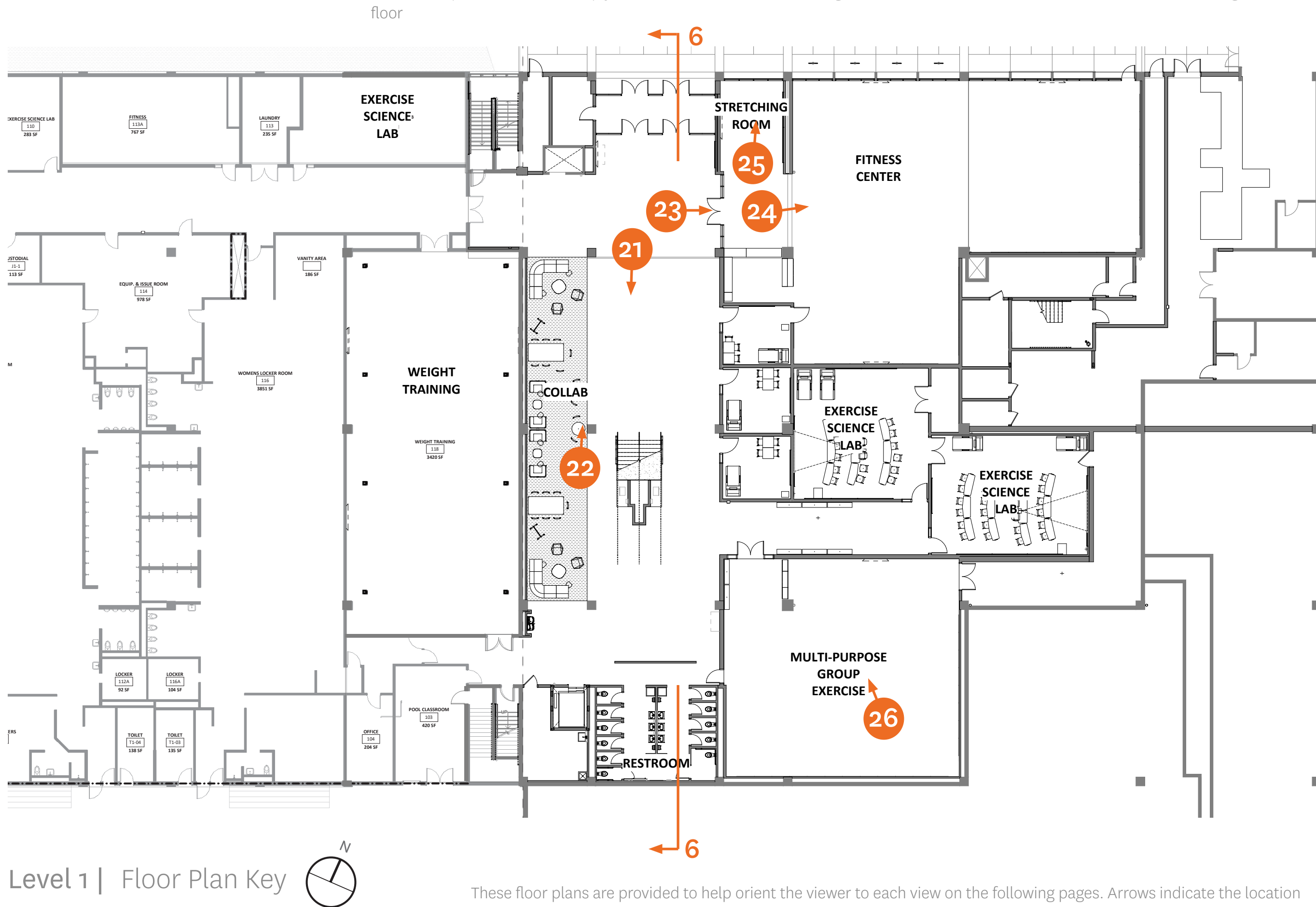

These floor plans are provided to help orient the viewer to each view on the following pages. Arrows indicate the location and direction of view, numbers correspond to the page of the view.

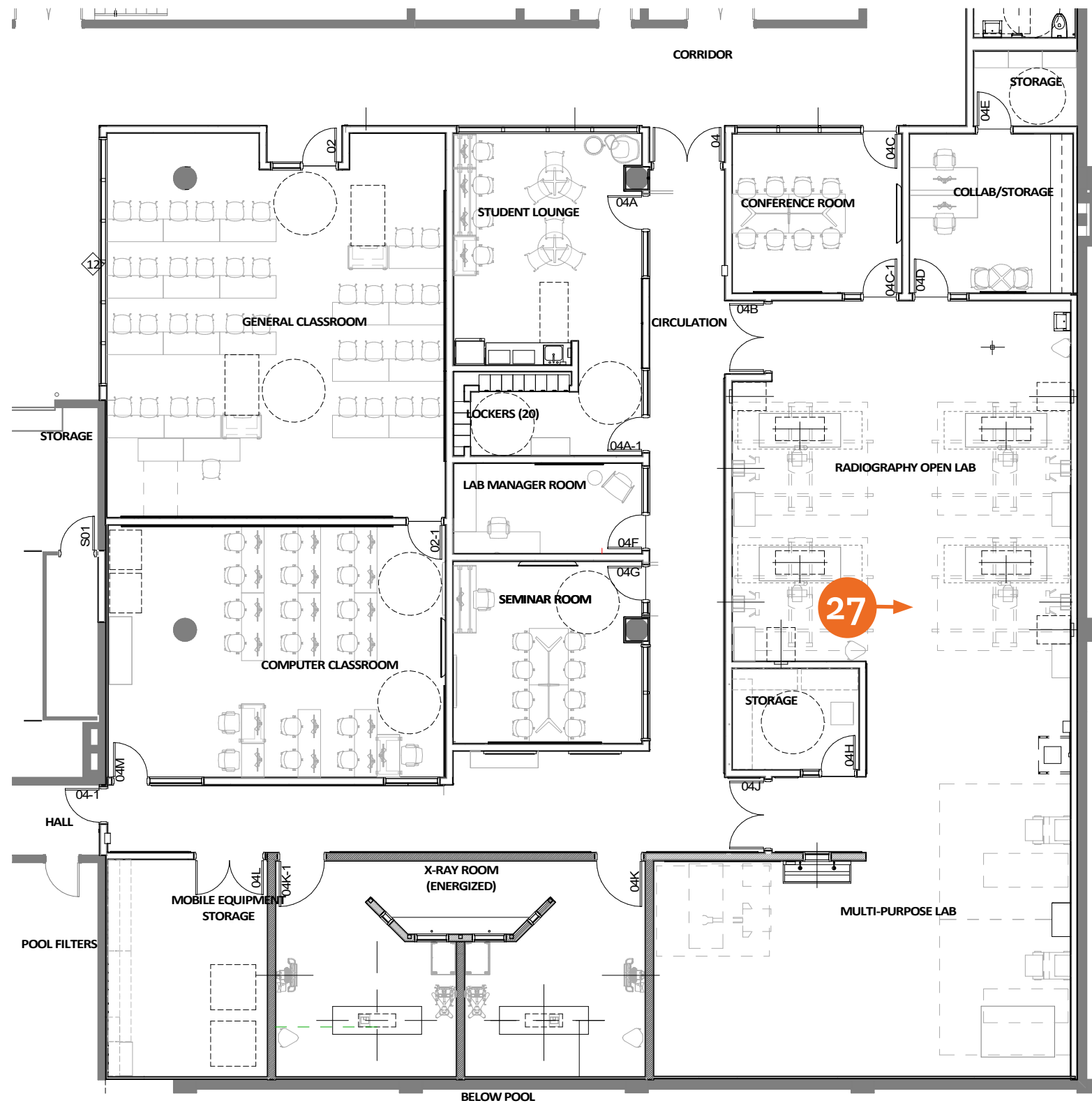

Level 0 | Floor Plan Key

These floor plans are provided to help orient the viewer to each view on the following pages. Arrows indicate the location and direction of view, numbers correspond to the page of the view.



Levels 1-3 | Atrium Section

View of the atrium cut through the building, looking west. New atrium stairs improve wayfinding; more collaboration spaces are in daylight; new acoustic panels buffer sound; recessed doorways with a yellow accent color support wayfinding; a new elevator unifies floors; collaboration spaces alternate around the atrium to create a variety of experiences; double-height decorative lights further connect the levels.



Level 3 | Large Open Collaboration Space

View of level 3 flexible multi-purpose collaboration space, which will be used for Architecture and Interior Design critique, among other uses, including students working together in small or large groups, or individually. Pin-up space continues into the corridor, and the view shows the new consolidated building entry from the north. The reclaimed wood is a sustainable material that also connects to the history of the building.



Level 3 | Atrium

View of the atrium cut through the building, looking west. New atrium stairs improve wayfinding; more collaboration spaces have access to daylight; new acoustic panels buffer sound; recessed doorways with a yellow accent color aid with wayfnding; a new elevator unifies floors; collaboration spaces alternate around the atrium to create a variety of experiences; double-height decorative lights further connect the levels.



Level 3 | Small Open Collaboration Space

View of level 3 looking toward the CC building. The comfortable collaboration area is just outside the building's largest meeting room.



Level 3 | Highlighted Classroom Entries

View showing level 3 corridor pin-up, architecture and interior design classroom entrances, and a new meeting room at the end of the corridor. A yellow accent color has been added at lab and classroom entries as a wayfinding strategy that continues throughout the building.



Level 3 | Typical General Purpose Classroom

View of a typical General Purpose Classroom. This one looks north over parking, and features several whiteboards, a connection to the outdoors, with light and views controlled by shades. This classroom's open ceiling configuration ties to the history of the renovated building.



Level 3 | Architecture and Interior Design Studio

View of an Architecture and Interior Design Studio on level 2, looking out to the south toward the CC building. This view highlights the interior experience of the building-wide color wayfinding strategy. The space features generous surfaces, including desk space, pin-up boards, and whiteboards.



Level 3 | Typical Meeting Room

View of a large meeting room on level 3, featuring a visual connection to the atrium, and a grounding color accent within the room.



Level 3 | All-User Restroom

View of level 3 all-user restrooms, featuring floor-to-ceiling individual toilet enclosures, shared sinks, hand-drying, and mirror area.



Level 2 | All-User Restroom

View of level 2 all-user restrooms featuring floor-to-ceiling individual toilet enclosures, baby changing table, shared sinks, hand-drying, and mirror area.



Level 2 | Open Collaboration Space

View of level 2 atrium space, looking south. This large, shared space offers collaboration areas at various scales, with a variety of furniture options for group or individual study. A green accent color highlights the nursing suite entry. Atrium spaces receive more natural light. Decorative lighting visually connects levels 2 and 3; acoustic treatment attenuates sound; repurposed wood connects to the building’s history.



Level 2 | Academic Offices Entry

View of level 2 consolidated academic office suite entry looking east. The green accent color indicates suite entries through the building, the new central stair offers a more direct, but visually lighter, connection between floors.



Level 3 | Academic Offices - Open Office Area

View of level 2 consolidated academic office space looking south to views of the courtyard between the HT building and the CC building.



Level 2 | Nursing Skills Lab

View of the Nursing Skills Lab, looking north. The lab features flexible learning space at the center, small enclosed rooms for hybrid teaching and testing at the perimeter.



Level 2 | Nursing Suite Simulation Room

View within the nursing suite, showing one of four patient simulation rooms with a proctor control room behind a mirrored glass window.



Level 1 | Open Collaboration Space - Looking South

View of level 1 looking south. The main atrium stairwell is now located further into space to create a more intuitive circulation path to and from the CC building. Collaboration space with reclaimed wood walls are shown to the right, PE/Exercise Science programs to the left.



Level 1 | Open Collaboration Space - Looking North

View of level 1 looking north, collaboration space to left with reclaimed wood walls features areas for collaboration and individual study. Circulation and entrance to the fitness center are shown to the right.



Level 1 | Fitness Center Entry

View of level 1 entry area looking east towards the fitness center--a new vestibule to the left provides thermal buffering for sustainability, bulletin boards will be installed at all major entries.



Level 1 | Fitness Center Reception

View looking east from the fitness center entry, the teaching/stretching space is to the immediate left, the check-in counter is to the immediate right.



Level 1 | Fitness Center Stretching Area

View of the fitness center, with the entry from Level 1 circulation shown at the far left. This view shows teaching/stretching space to the left and open space for various exercise equipment to the right. With windows to the exterior, the fitness center offers connection to nature without being on a main circulation path.



Level 1 | Multi-Purpose Group Exercise

View of multi-purpose group exercise space with wood floors, mirrors, and ceiling-suspended TRX system.



Level o | Medical Imaging

Photograph of the radiography open lab with flexible lab space currently outfitted with four non-energized OTC machines, with an adjacent conference room and storage room.