

FACT SHEET | **Portland Community College Swan Island Trades Center** Mar. 2016



PCC's new Swan Island Trades Center opened in fall 2014. The new facility provides more than 20,000 square feet of classroom and lab space for career technical education and professional development classes. PCC also maintains a welding classroom and welding shop at Vigor Industrial at its nearby shipyard at 555 N. Channel Ave.

OVERVIEW

Thanks to the 2008 voter-approved capital construction bond, PCC's Swan Island Trades Center offers exceptional opportunities for students interested in career technical education (CTE) and professional development classes.

The new facility provides classroom and lab space for CTE courses formerly held by the Trades & Industry Department at the Cascade Campus. In addition, the center offers a full range of professional training and business development classes for new and current members of the workforce. Those wishing to further their capabilities in management, budgeting, leadership, finance and other workplace development skills will find a number of diverse offerings for continuing education.

The new Trades Center and nearby Cascade Campus, along with expertise from PCC's CLIMB Center for Advancement, will be the premier resource for continuing education, training/retraining and professional development for Swan Island businesses.

Combined with additional CTE programming offered at campuses and centers throughout the college, PCC provides skills and job training for more than 20 occupations in the trades.

PCC purchased the five-acre Swan Island property and 11,000-square-foot building from the State of Oregon. Recognizing the educational value of siting a training program in one of Portland's most active industrial business communities, as well as the potential to create jobs, the state Legislature authorized \$1 million from the Department of Community College and Workforce Development for the building's renovation and expansion. With \$5.4 million from PCC's bond program, and the \$1 million from the state, the college initiated design and construction of the center in summer 2013 and opened in time for fall term 2014.

CLASSES

A variety of degrees, certificates, training programs and apprenticeships are offered at the new Trades Center. They include:

Associate of Applied Science degree:

Facilities Maintenance Technology

Certificates of Completion:

Facilities Maintenance Technology

HVAC Installers

Apprenticeships:

Millwright

Industrial Mechanics

Limited Maintenance Electrician

Manufacturing Plant Electrician

Stationary Engineer

Training Program:

Limited Building Maintenance Electrician

As part of the Oregon Community College Apprenticeship Consortium, PCC offers additional opportunities to earn Associate of Applied Science degrees and Certificates of Completion. This innovative statewide program, one of the first in the nation, has gained the attention of the U.S. Departments of Education and Labor. It is available to all journeypersons who have completed an approved construction trades apprenticeship via one of Oregon's 17 community colleges.

Additional AAS degrees can be earned in Industrial Mechanics and Maintenance Technology, Electrical Apprenticeship Technologies, and Construction Trades-General Apprenticeships. Certificates of Completion can be earned in Electrician Apprenticeship, Construction Trades-General, and Industrial Mechanics and Maintenance Technology.

The benefits of this pathway program are two-fold: It allows apprentices to further their knowledge, upgrade their skills and earn a degree wherever their job may take them, and provides Oregon businesses like those on Swan Island with a wealth of highly skilled workers.

For Swan Island Trades Center class information please call (971) 722-5650 or visit www.pcc.edu/schedule

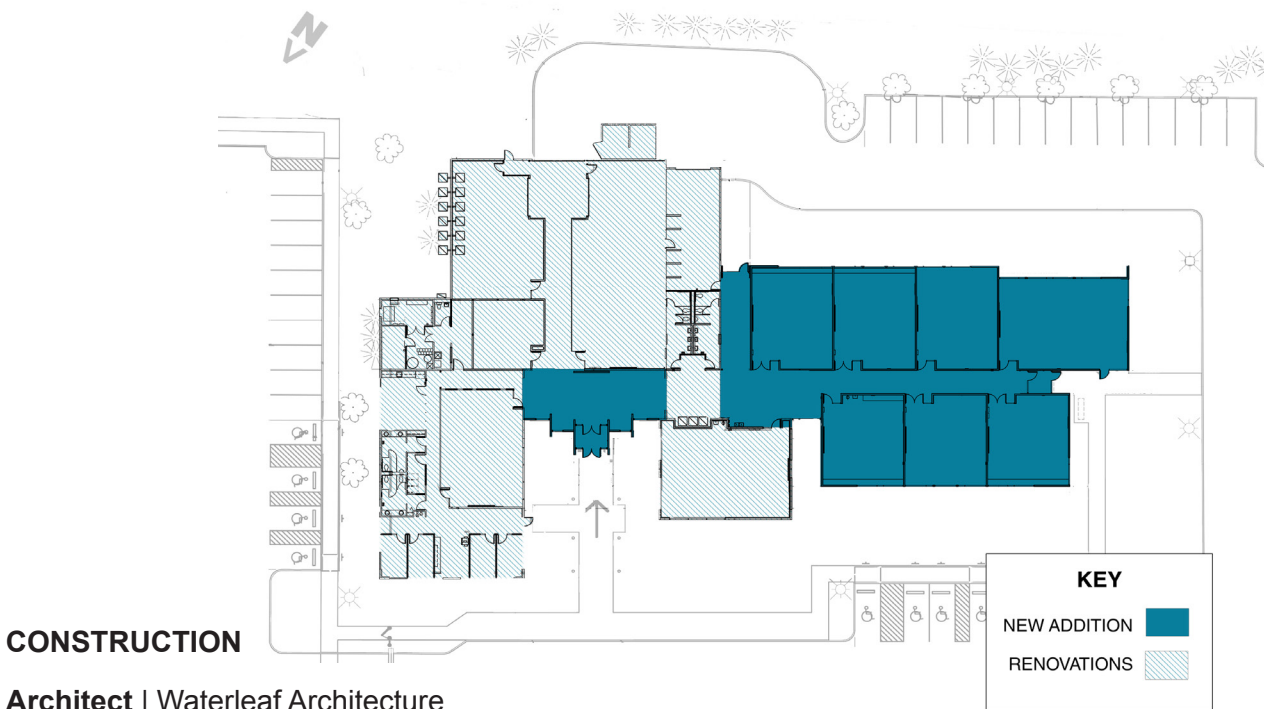

CONSTRUCTION

Architect | Waterleaf Architecture

General Contractor | JE Dunn Construction

JE Dunn Construction's employment of state-certified minority-owned, women-owned or emerging small businesses (MWESB) as subcontractors is a result of the college's goal to reinvest bond dollars into the local economy, mentor smaller construction companies, and spread work and opportunity to MWESB businesses. To date, the bond program has entered into more than 500 contracts with MWESB firms.

CONTACT INFORMATION

For more information on the PCC Bond Program, visit bond.pcc.edu or call the Helpline at (971) 722-8454.