

GENERAL NOTES

- ALL WORK IN PUBLIC RIGHT-OF-WAY UNDER SEPARATE PUBLIC WORKS PERMIT TH0179.

OTHER UTILITY NOTES

- UNDERGROUND TELECOM CONDUIT, UNDER SEPARATE PERMIT. COORDINATE WITH LUMEN LOCAL, FORREST SEMANCIK, 206-440-4901.
- GAS CONNECTION TO BUILDING.
- EXISTING UTILITY POLE AND GUY WIRE TO BE RELOCATED, UNDER SEPARATE PERMIT. COORDINATE WITH PACIFIC POWER, JOHN MOUDY 503-880-1479.
- PAD MOUNTED 575 TRANSFORMER ON PAD VAULT.
- POT HOLE TO FIELD VERIFY LOCATION AND ELEVATION OF EXISTING CENTURYLINK DUCT BANK AND 2" GAS MAIN PRIOR TO CONSTRUCTION.
- PROPOSED SERVICE WORK BY LUMEN NATIONAL, UNDER SEPARATE PERMIT. COORDINATE WITH LUMEN NATIONAL, MASOOD ZEERAK 720-888-8568.
- SITE LIGHTING, SEE ELECTRICAL PLANS.
- REMOVE EXISTING UTILITY POLE AND GUY WIRE, UNDER SEPARATE PERMIT. COORDINATE WITH PACIFIC POWER, JOHN MOUDY 503-880-1479.

SANITARY NOTES

- 8" SANITARY SEWER CONNECTION FROM BUILDING.
- EXISTING PUBLIC SANITARY SEWER MANHOLE (SMH AAN735), RIM = 148.02
EX 8" IE, IN(N)=135.05
EX 8" IE, OUT(E)=134.78
EX 8" IE, IN(W)=134.92
- CONNECTION TO 8" SANITARY MAIN LINE, INSTALL 60 LF 6" SEWER SERVICE AT S=0.0200, 8" MAIN IE = 136.87
- EXISTING PUBLIC UPSTREAM SANITARY SEWER MANHOLE (SMH AAN736), RIM = 151.37
EX 8" IE, IN(S)=143.53
EX 8" IE, OUT(E)=143.41
- CONNECTION TO 8" SANITARY MAIN LINE, INSTALL 50 LF 6" SEWER SERVICE AT S=0.0200, 8" MAIN IE = 139.96

DOMESTIC WATER/FIRE NOTES

- BUILDING MOUNTED FIRE DEPARTMENT CONNECTION, SEE FIRE SPRINKLER PLANS.
- BELOW-GRADE PREMISES ISOLATION (PI) DCDA TO BE INSTALLED IN VAULT AT PROPERTY LINE ON NEW FIRE LINE WATER SERVICE, PER DETAIL 7/C-300.
- INSTALL 6" FIRE LINE BY PORTLAND WATER BUREAU UNDER SEPARATE PERMIT. CONTRACTOR TO CONNECT TO THE SHORT STUB-OUT ON THE BACK-SIDE OF THE FIRE LINE CURB GATE VALVE.
- 4" DOMESTIC WATER SERVICE, BY PORTLAND WATER BUREAU UNDER SEPARATE PERMIT.
- INSTALL 4" METER BY PORTLAND WATER BUREAU UNDER SEPARATE PERMIT. CONTRACTOR TO CONNECT TO THE SHORT STUB-OUT ON THE BACK-SIDE OF THE NEW WATER METER BOX.
- DOMESTIC WATER CONNECTION TO BUILDING, SEE PLUMBING PLANS FOR CONTINUATION.
- FIRE PROTECTION CONNECTION TO BUILDING, SEE FIRE SPRINKLER PLANS FOR CONTINUATION.
- PROTECT EXISTING 2" WATERLINE, FIELD VERIFY LOCATION AND ELEVATION PRIOR TO CONSTRUCTION.
- ABOVE-GRADE 4" PREMISES ISOLATION (PI) RPBA TO BE INSTALLED IN HEATED ENCLOSURE.
- WATER CONNECTION FOR NORTH BUILDING, SEE PLUMBING FOR CONTINUATION.

STORMWATER NOTES

- ROOF DRAIN CONNECTION.
- STORMWATER SEDIMENT MANHOLE, PER DETAIL 4/C-300, RIM = 140.89
IE, 6" IN(SW) = 138.20
IE, 6" IN(N) = 138.66
IE, 6" IN(S) = 137.96
IE, 8" OUT(W) = 137.76
- STORMWATER DRYWELL, 20FT PERFORATED SECTION, PER DETAIL 5/C-300, RIM = 144.11
IE = 136.96
- STORMWATER DRYWELL, 20FT PERFORATED SECTION, PER DETAIL 5/C-300, RIM = 141.75
IE = 137.36
- BUILDING FOUNDATION DRAIN CONNECTION TO STORM WITH CLEANCHECK BACKWATER VALVE.
- 4" PERFORATED PIPE WALL DRAIN, TYP. CONNECT TO STORMWATER LINE.
- INSTALL NDS 9" SQUARE CATCH BASIN WITH BLACK ATRIUM GRATE OR APPROVED EQUAL, RIM=146.75
IE = 144.87
- EXISTING PUBLIC DRYWELL (AD0222)
- EXISTING PUBLIC SDMH (AAR46)
- INSTALL NDS 9" SQUARE CATCH BASIN WITH BLACK ATRIUM GRATE OR APPROVED EQUAL, RIM = 140.42
IE = 138.92
- INSTALL NDS 9" SQUARE CATCH BASIN WITH BLACK ATRIUM GRATE OR APPROVED EQUAL, RIM = 143.33
IE = 140.52
- INSTALL NDS 9" SQUARE CATCH BASIN WITH BLACK ATRIUM GRATE OR APPROVED EQUAL, RIM = 141.84
IE = 140.34
- INSTALL NDS 9" SQUARE CATCH BASIN WITH BLACK ATRIUM GRATE OR APPROVED EQUAL, RIM = 145.28
IE = 140.36
- INSTALL NDS 9" SQUARE CATCH BASIN WITH BLACK ATRIUM GRATE OR APPROVED EQUAL, RIM = 146.20
IE = 143.97
- INSTALL NDS 9" SQUARE CATCH BASIN WITH BLACK ATRIUM GRATE OR APPROVED EQUAL, RIM = 146.58
IE = 143.71
- INSTALL NDS 9" SQUARE CATCH BASIN WITH BLACK ATRIUM GRATE OR APPROVED EQUAL, RIM = 146.58
IE = 143.55
- INSTALL NDS 9" SQUARE CATCH BASIN WITH BLACK ATRIUM GRATE OR APPROVED EQUAL, RIM = 146.67
IE = 145.10
- INSTALL NDS 9" SQUARE CATCH BASIN WITH BLACK ATRIUM GRATE OR APPROVED EQUAL, RIM = 146.46
IE = 144.98
- INSTALL NDS 9" SQUARE CATCH BASIN WITH BLACK ATRIUM GRATE OR APPROVED EQUAL, RIM = 146.58
IE = 144.58
- INSTALL NDS 9" SQUARE CATCH BASIN WITH BLACK ATRIUM GRATE OR APPROVED EQUAL, RIM = 146.58
IE = 144.72
- INSTALL NDS 9" SQUARE CATCH BASIN WITH BLACK ATRIUM GRATE OR APPROVED EQUAL, RIM = 146.75
IE = 145.22
- INSTALL NDS 9" SQUARE CATCH BASIN WITH BLACK ATRIUM GRATE OR APPROVED EQUAL, RIM = 146.58
IE = 144.59
- INSTALL NDS 9" SQUARE CATCH BASIN WITH BLACK ATRIUM GRATE OR APPROVED EQUAL, RIM = 146.58
IE = 143.81
- INSTALL NDS 9" SQUARE CATCH BASIN WITH BLACK ATRIUM GRATE OR APPROVED EQUAL, RIM = 146.75
IE = 143.64
- INSTALL NDS 9" SQUARE CATCH BASIN WITH BLACK ATRIUM GRATE OR APPROVED EQUAL, RIM = 146.52
IE = 143.12
- INSTALL NDS 9" SQUARE CATCH BASIN WITH BLACK ATRIUM GRATE OR APPROVED EQUAL, RIM = 144.92
IE = 142.85
- INSTALL CLEANOUT TO GRADE, PER DETAIL 1/C-300.
- INSTALL NDS 9" SQUARE CATCH BASIN WITH BLACK ATRIUM GRATE OR APPROVED EQUAL, RIM = 144.92
IE = 142.60
- INSTALL NDS 9" SQUARE CATCH BASIN WITH BLACK ATRIUM GRATE OR APPROVED EQUAL, RIM = 147.60
IE = 145.41
- INSTALL NDS 9" SQUARE CATCH BASIN WITH BLACK ATRIUM GRATE OR APPROVED EQUAL, RIM = 147.05
IE = 145.21
- INSTALL NDS 9" SQUARE CATCH BASIN WITH BLACK ATRIUM GRATE OR APPROVED EQUAL, RIM = 146.98
IE = 144.11
- INSTALL NDS 9" SQUARE CATCH BASIN WITH DUCTILE IRON SQUARE GRATE, RIM = 146.98
IE = 143.77
- INSTALL NDS 9" SQUARE CATCH BASIN WITH BLACK ATRIUM GRATE OR APPROVED EQUAL, RIM = 144.12
IE = 140.42
- INSTALL NDS 9" SQUARE CATCH BASIN WITH BLACK ATRIUM GRATE OR APPROVED EQUAL, RIM = 143.25
IE = 140.27
- INSTALL NDS 9" SQUARE CATCH BASIN WITH BLACK ATRIUM GRATE OR APPROVED EQUAL, RIM = 142.76
IE = 140.29
- INSTALL 24" CATCH BASIN PER DETAIL 7/C-300, RIM = 141.50
IE = 140.00
- INSTALL 24" CATCH BASIN PER DETAIL 7/C-300, RIM = 141.60
IE = 139.93
- CONNECT TO EXISTING CONTECH WATER QUALITY VAULT, IE = 139.70
- INSTALL 3" WIDE TRENCH DRAIN (11 LF) NDS MINI-CHANNEL DRAIN BODY WITH DUCTILE IRON HEEL-PROOF GRATE "RAIN" BY IRONAGE DESIGNS OR APPROVED EQUAL. INSTALL SUMP AND SNOOT AT TRENCH DRAIN CONNECTION TO SITE STORM, RIM = 148.92
IE = 144.53
- STORMWATER CONNECTION TO BUILDING, SEE PLUMBING FOR ROUTING.
- INSTALL 9" CATCH BASIN WITH DUCTILE IRON SQUARE GRATE OR APPROVED EQUAL, RIM = 148.03
IE = 141.90
- CONNECT TO EXISTING CLEANOUT, EXISTING 8" IE = 139.32.
- STORMWATER CONNECTION FROM BUILDING, SEE PLUMBING FOR ROUTING.
- FOUNDATION DRAIN, SEE DETAIL 6/C-300
- INSTALL NDS 9" SQUARE CATCH BASIN WITH BLACK ATRIUM GRATE OR APPROVED EQUAL, RIM = 147.67
IE = 146.08
- INSTALL NDS 9" SQUARE CATCH BASIN WITH BLACK ATRIUM GRATE OR APPROVED EQUAL, RIM = 146.98
IE = 145.16
- INSTALL NDS 9" SQUARE CATCH BASIN WITH BLACK ATRIUM GRATE OR APPROVED EQUAL, RIM = 146.90
IE = 142.62

23-027 Attachment A

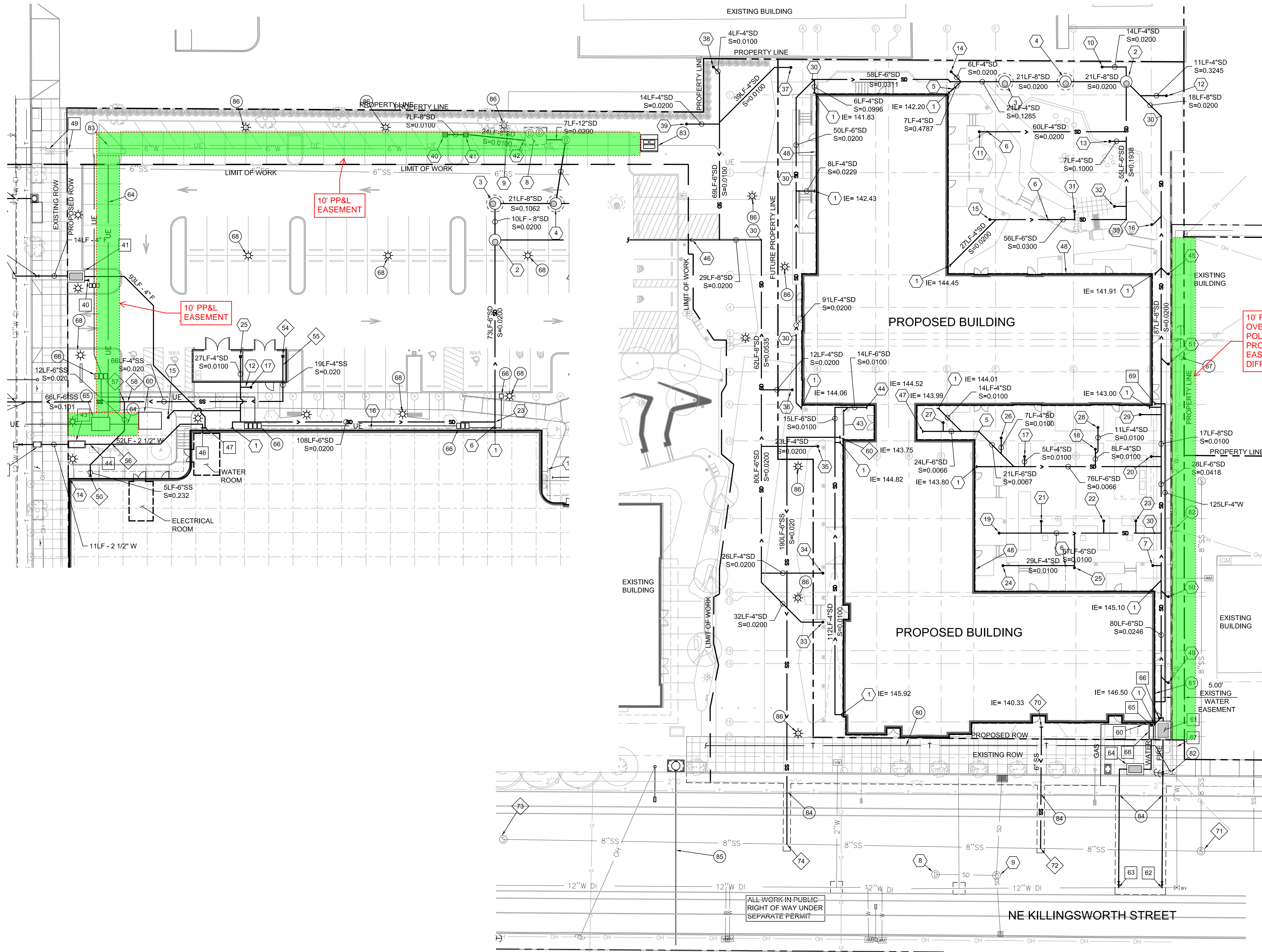

UTILITY PLAN

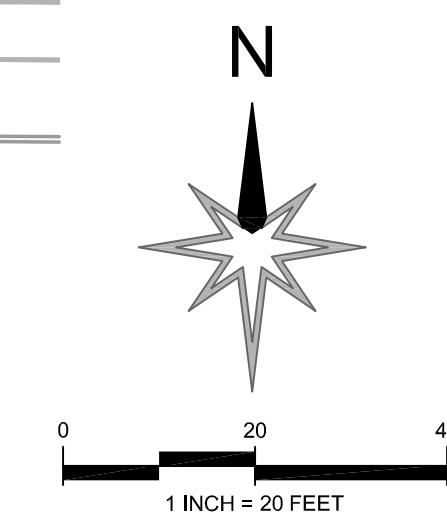

ARCHITECTS
HACKER
 555 SE MLK Jr. Blvd, Suite 501, Portland, OR 97214
 homeforward
VEGA
 CIVIL ENGINEERING LLC
 503.349.1381 | WWW.VEGACIVIL.COM

REGISTERED PROFESSIONAL ENGINEER
 89,412
 OREGON
 SEP 10, 2010
 KENNEDY F. MESALANA
 EXPIRES: 6/30/2022

STAMP
 REVISION NO. DATE

KEY PLAN - (NTS)

TRUE NORTH PLAN NORTH
KILLINGSWORTH HOUSING

HOME FORWARD
 5600 NE 42ND
 PORTLAND, OR 97218
 ISSUANCE
 100% CD
 PROJECT NUMBER
 2003
 DATE
 JAN 14, 2022
 SCALE

DRAWING TITLE
UTILITY PLAN

SHEET NUMBER
C-200